

Kodama Inc.
San Francisco, CA
USA

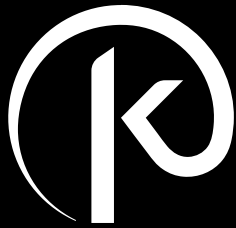

Welcome to **KODAMA**

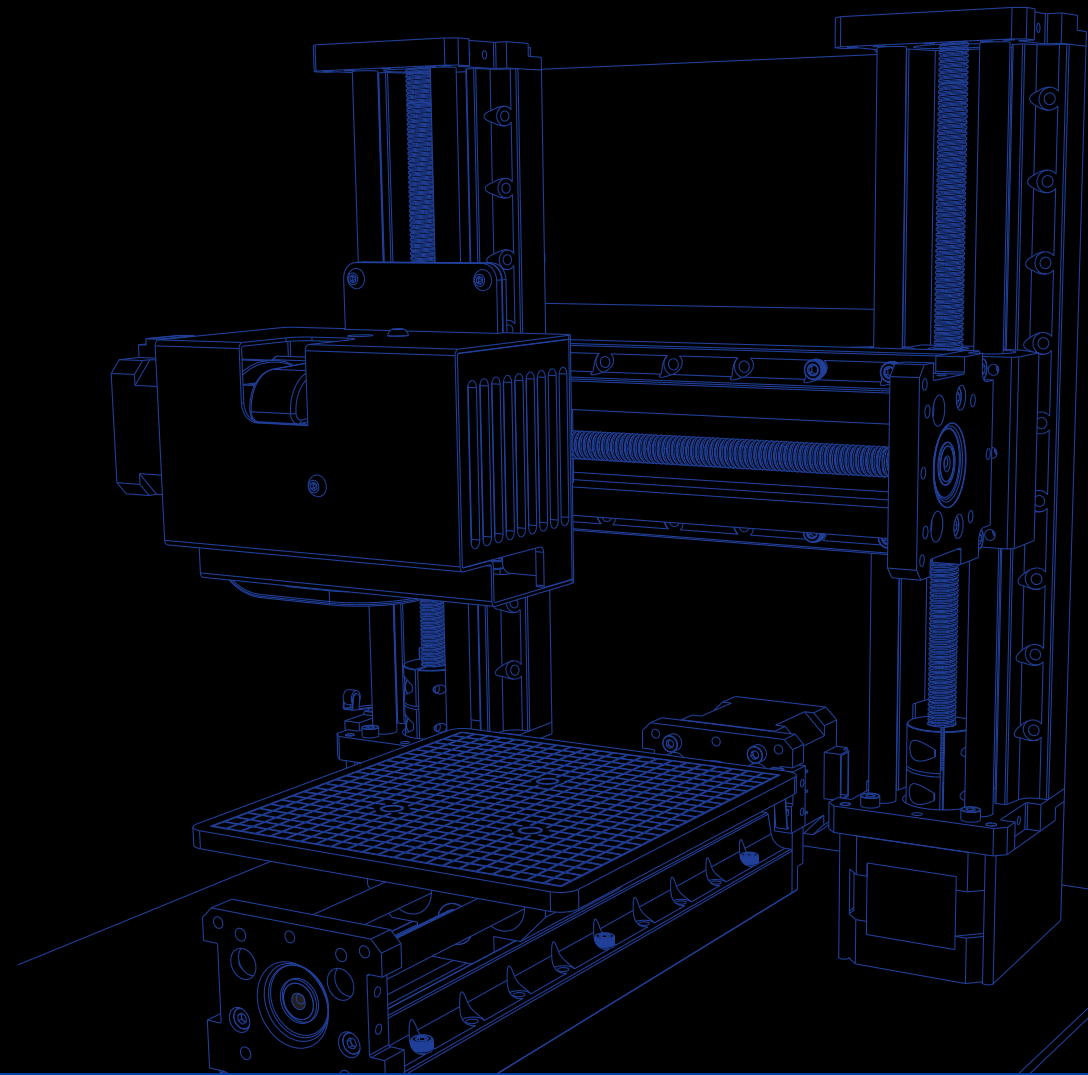

Please contact
support@trinus3d.com
with any questions, comments or concerns.

TRINUS[®]

ASSEMBLY INSTRUCTIONS

TOOLS & SCREWS

COMPONENTS

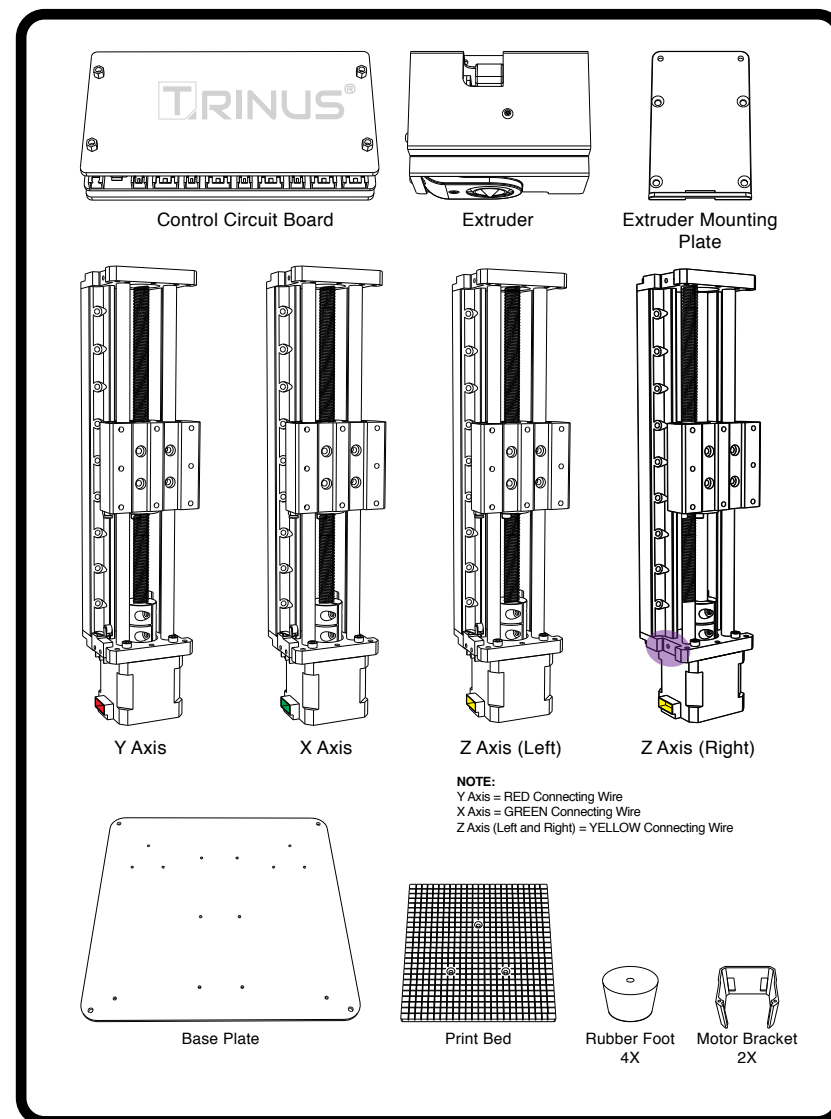
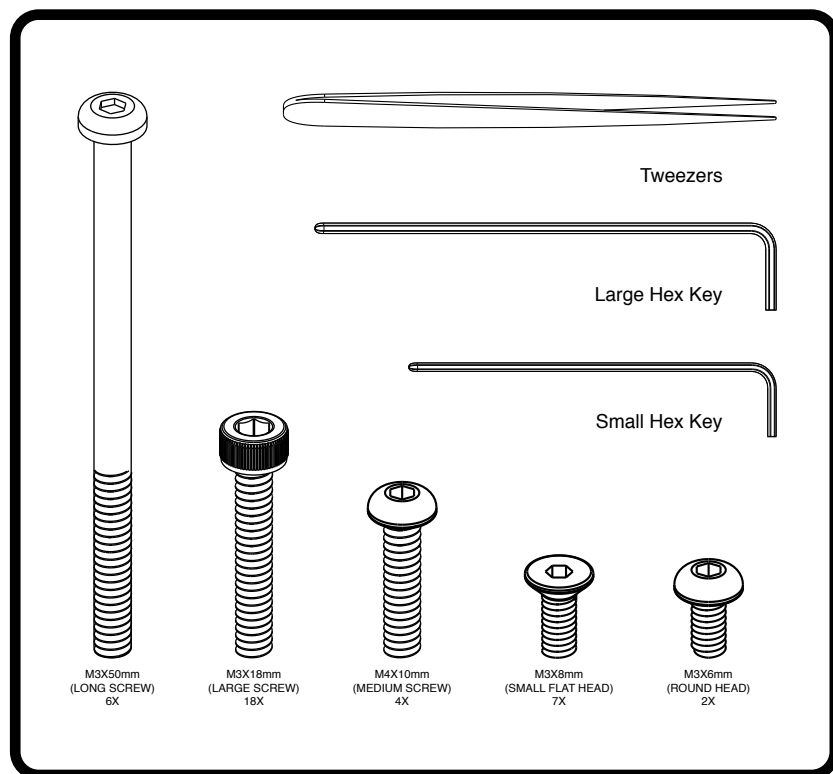

STEP 1

1

TRINUS[®]
Machine Body

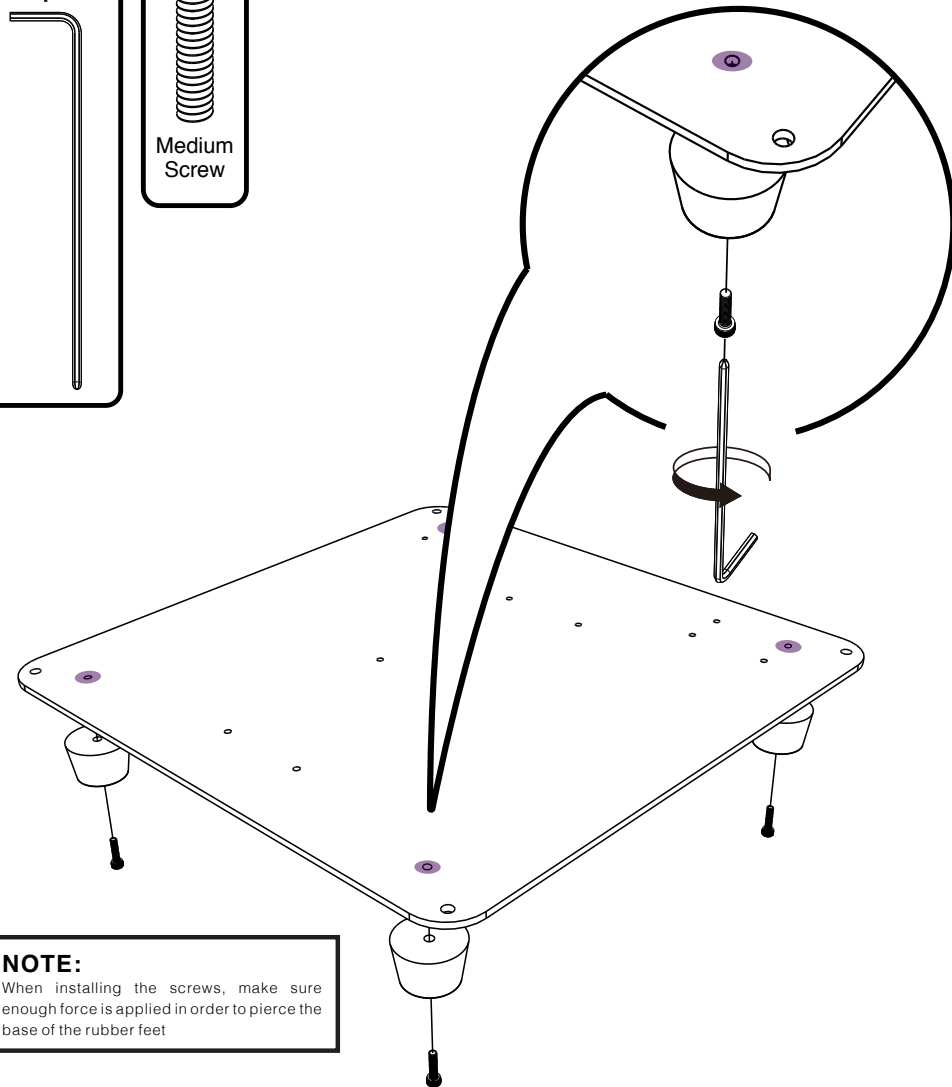
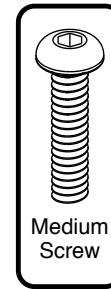
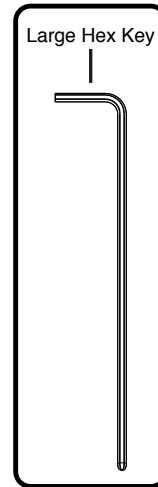

NOTE:

When installing the screws, make sure enough force is applied in order to pierce the base of the rubber feet

Installation of Base Plate and the Rubber Feet

STEP 2

STEP 3

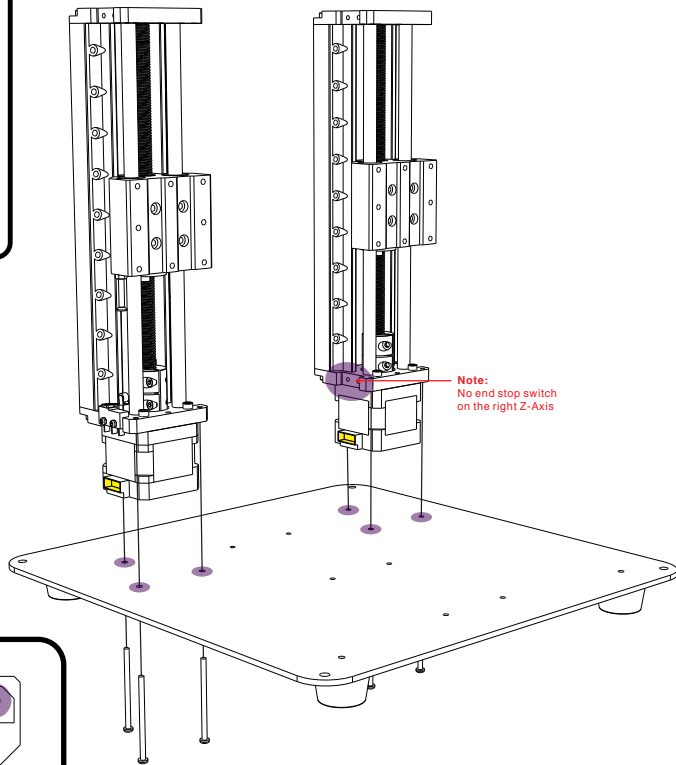
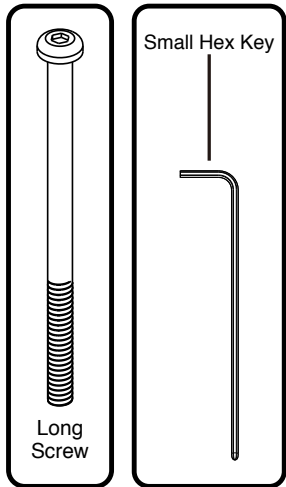

Note:
No end stop switch
on the right Z-Axis

Z-Axis Installation

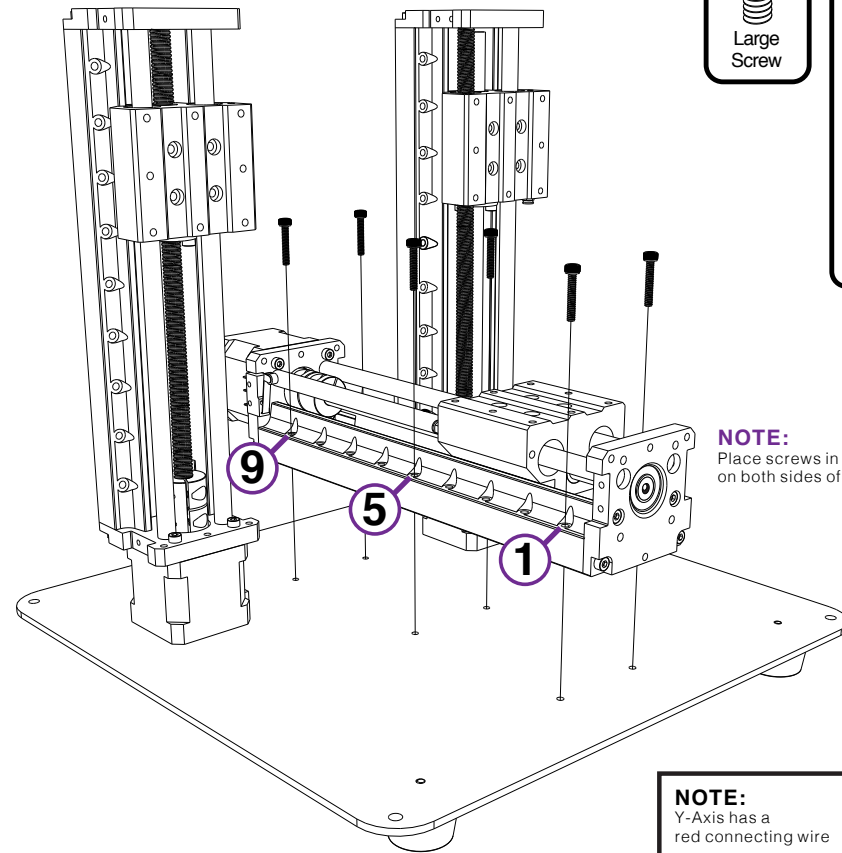
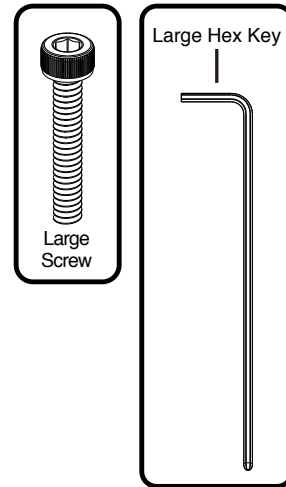
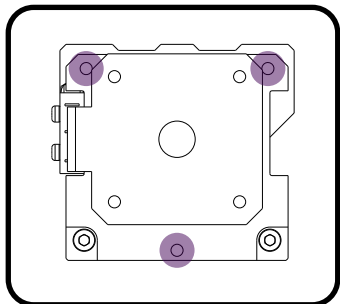

NOTE:
Place screws in positions 1, 5 & 9
on both sides of Y module

NOTE:
Y-Axis has a
red connecting wire

Place the Y-Axis in alignment with the Screw Mounts

STEP 4

STEP 5

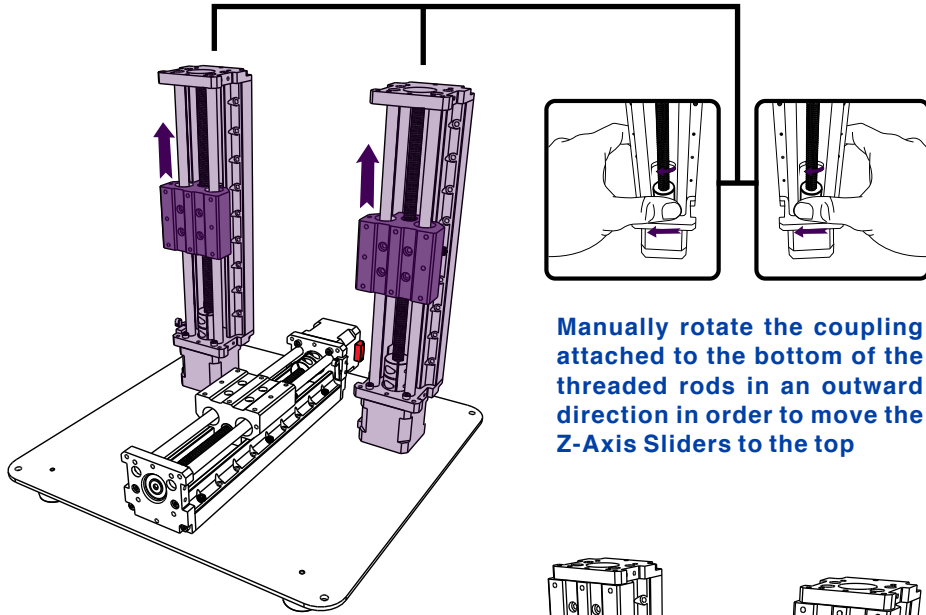

Manually rotate the coupling attached to the bottom of the threaded rods in an outward direction in order to move the Z-Axis Sliders to the top

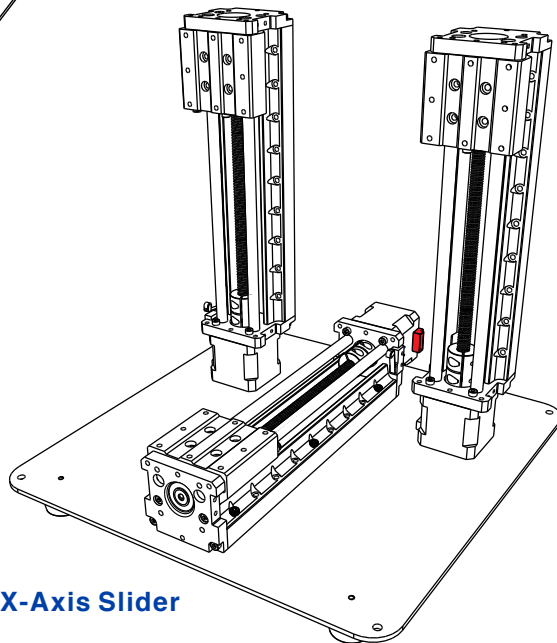

Now start to install the X-Axis Slider

Position of the screws for X-Axis assembly

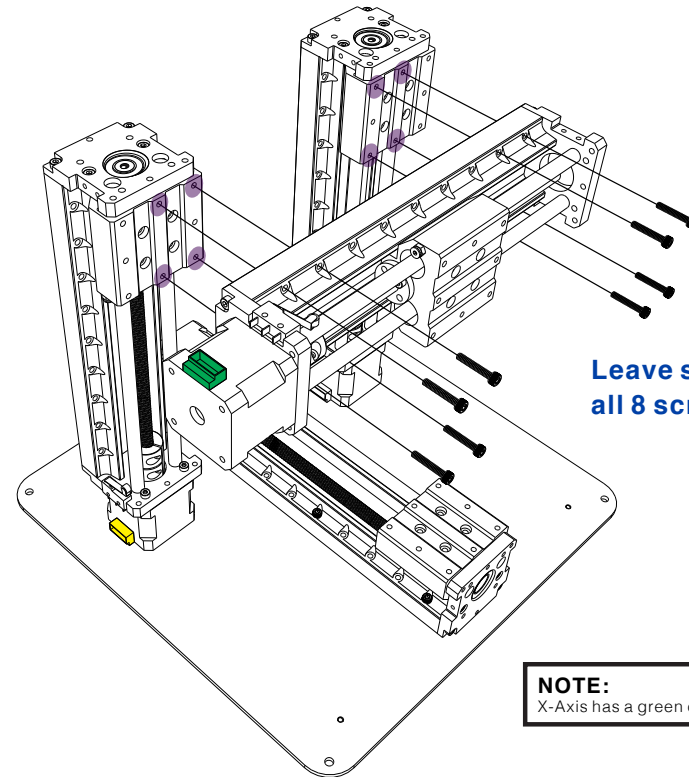
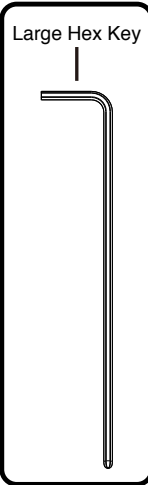
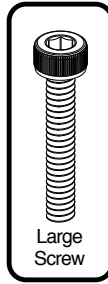
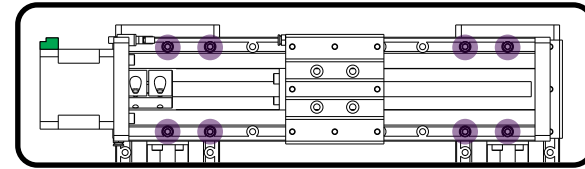

Leave screws loose until all 8 screws are inserted

NOTE:
X-Axis has a green connecting wire

STEP 6

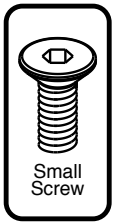
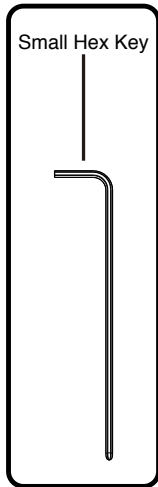

Install the Extruder Mounting Plate onto the face of X-Axis

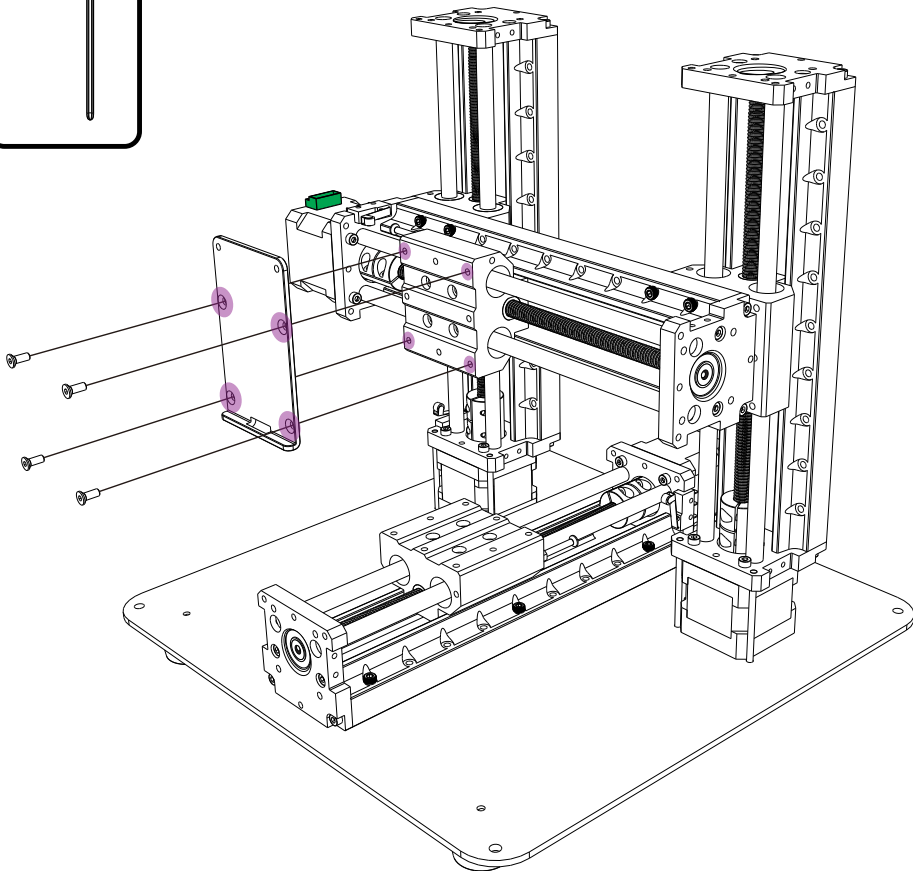

STEP 7

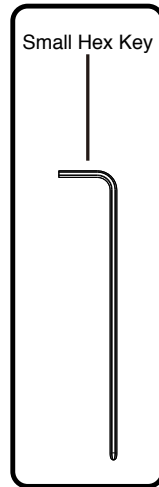
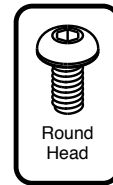
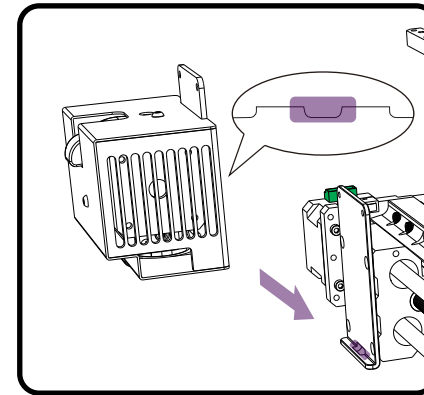

Attach the Extruder to the Extruder Mounting Plate, taking note of the illustration above

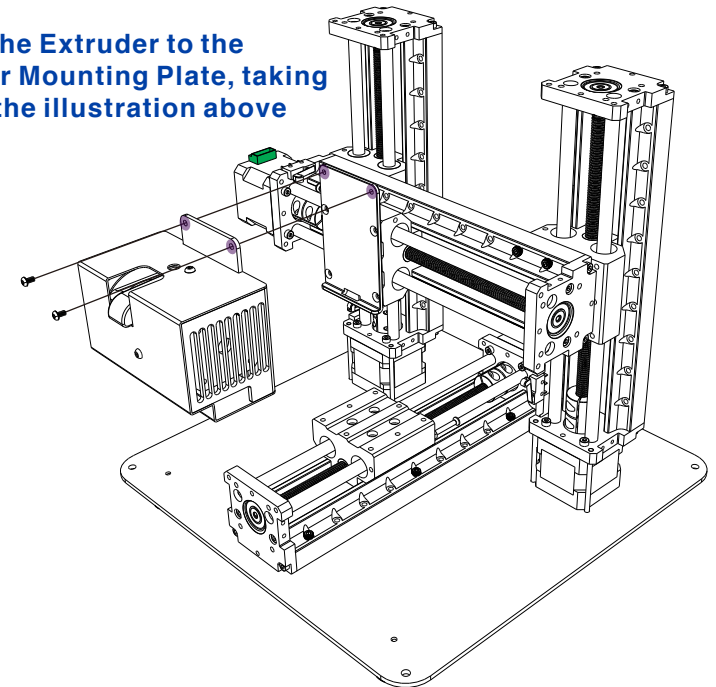

STEP 8

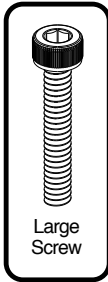
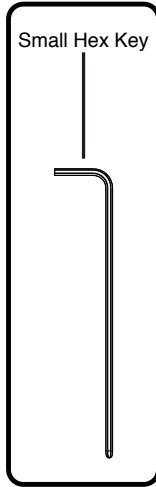

Position of the screws
for Circuit Board Assembly

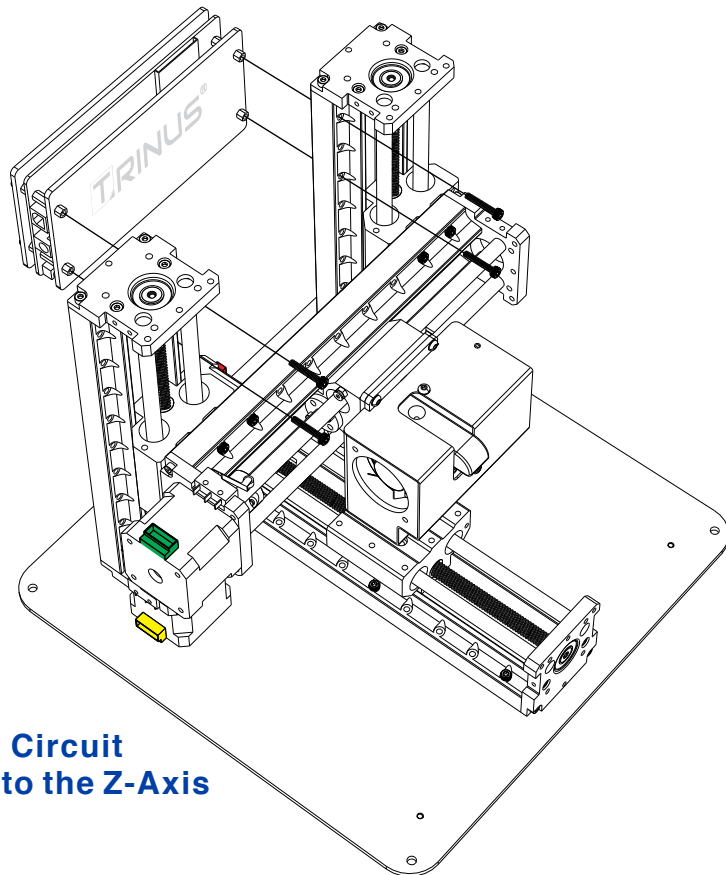

Attach Circuit Board to the Z-Axis

STEP 9

Install the Print Bed onto the Y-Axis Slider ensuring the single screw is in the back and the two screws are facing forward

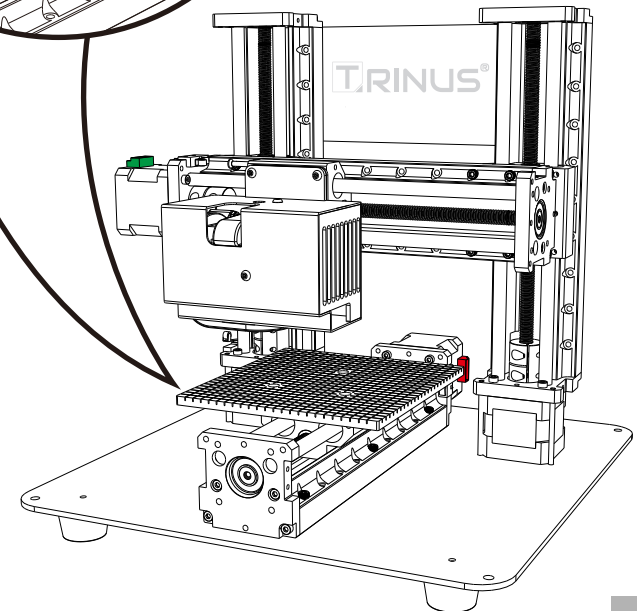
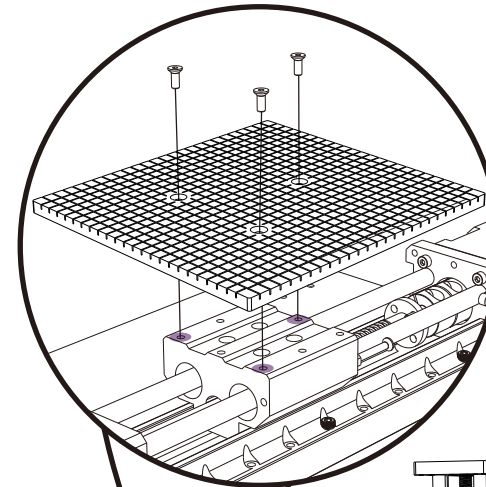
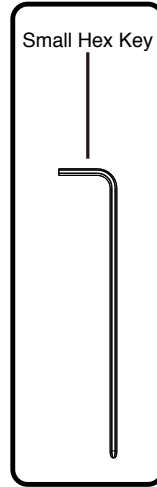
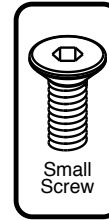

STEP 10

DONE

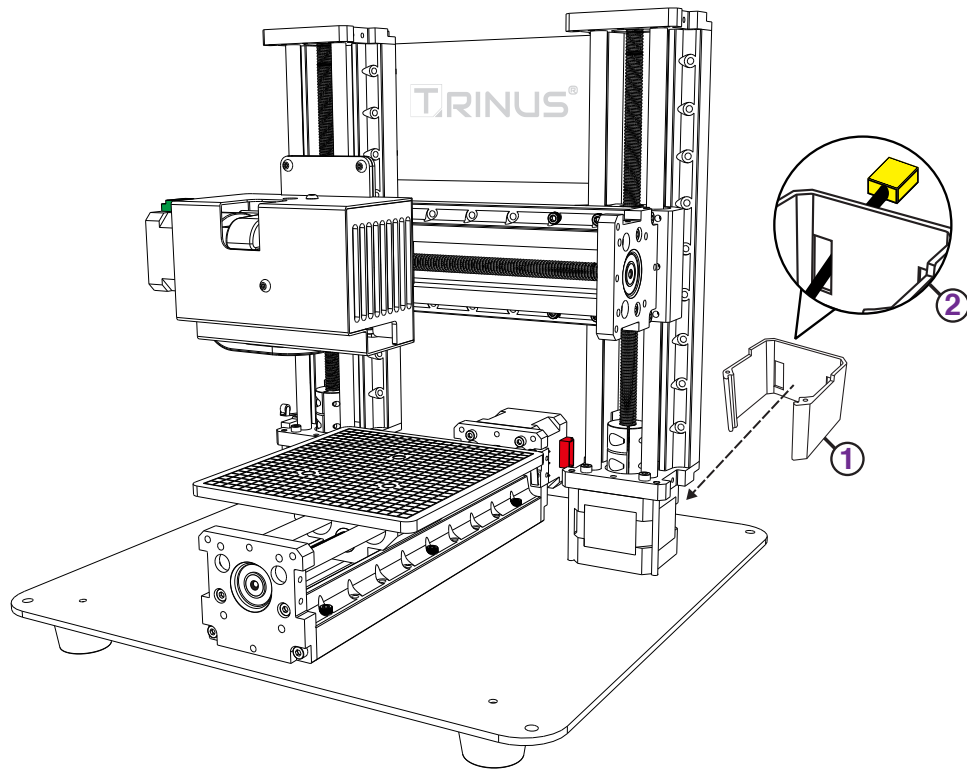

1. Place cabling of the Z-Axis motor through the left hole of the Motor Bracket
2. Install Motor Bracket to the back of the motors as illustrated above

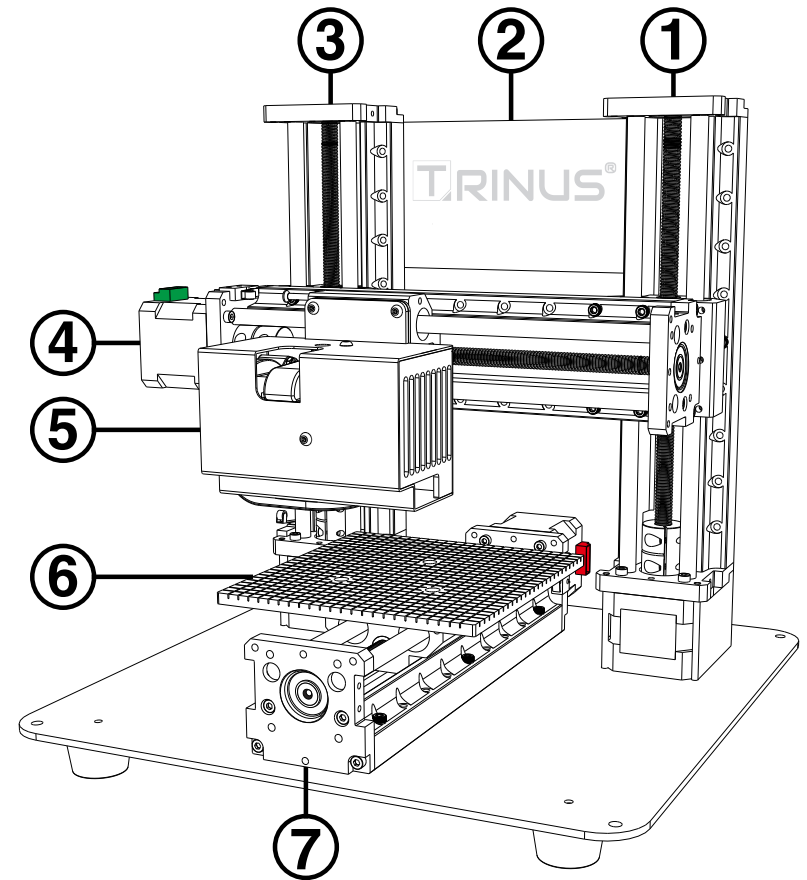

- 1 Z-Axis Column (Right)
- 2 Circuit Board
- 3 Z-Axis Column (Left)
- 4 X-Axis Column
- 5 Extruder
- 6 Print Bed
- 7 Y-Axis Column

STEP 1

Overview of the Control Circuit Board Module

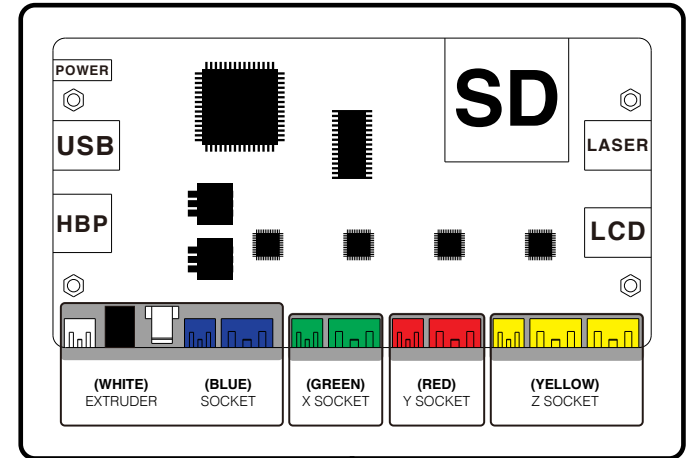

2

TRINUS[®]

Circuit Board Parts

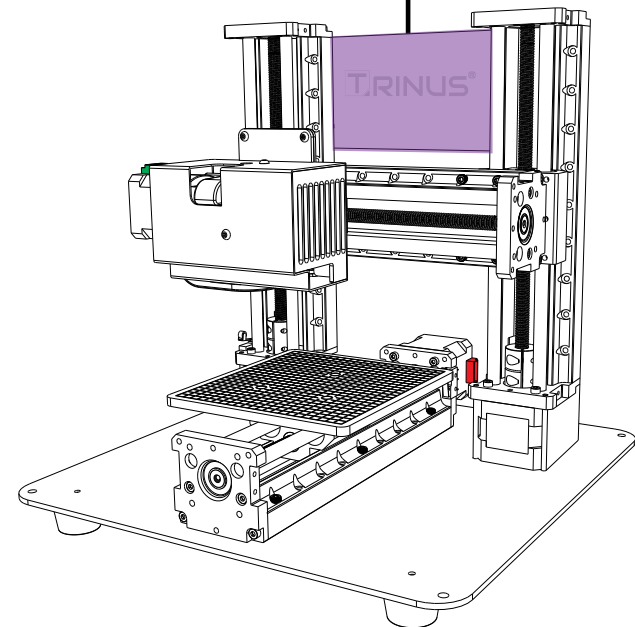

STEP 2

Connecting wires for the Extruder Module

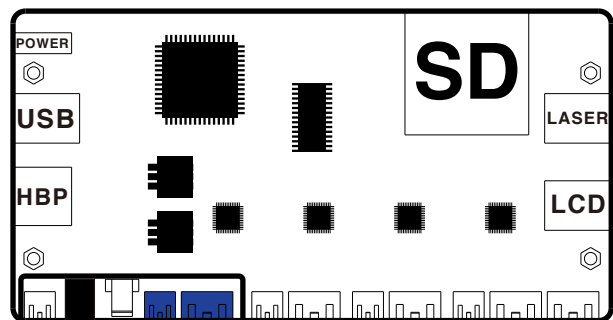

Blue

Note:
Ensure the clip of the cable is facing forward

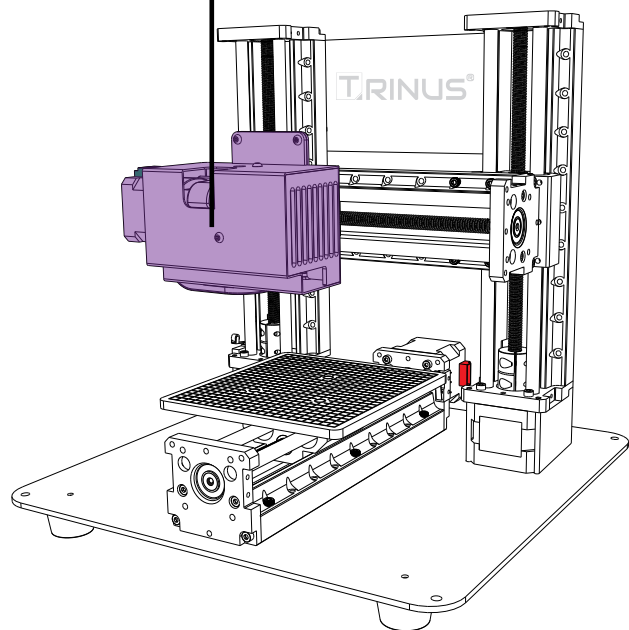

STEP 3

Connecting wires for the X-Axis Module

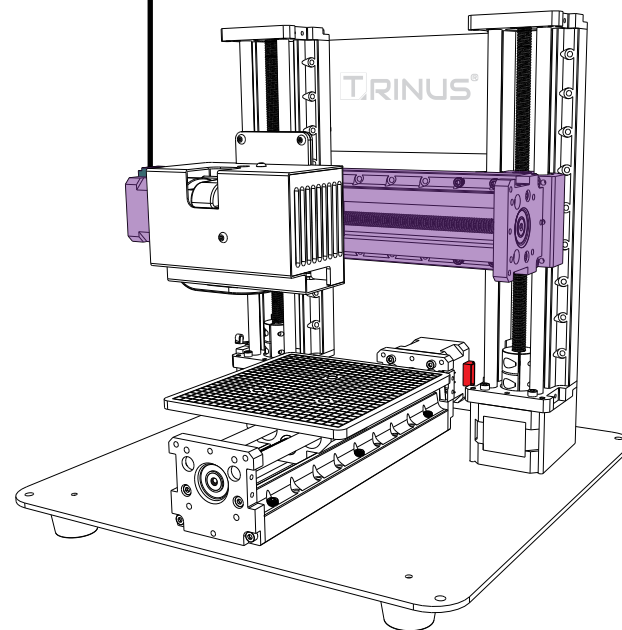
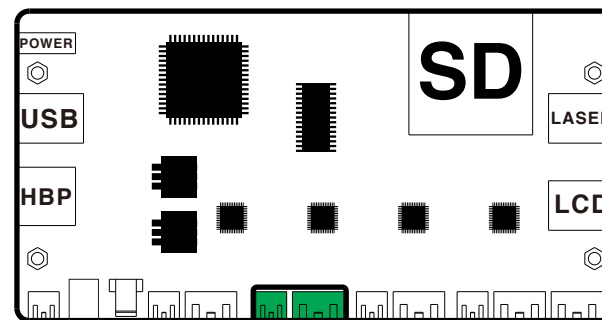

STEP 4

DONE

Connecting wires for the Y-Axis Module

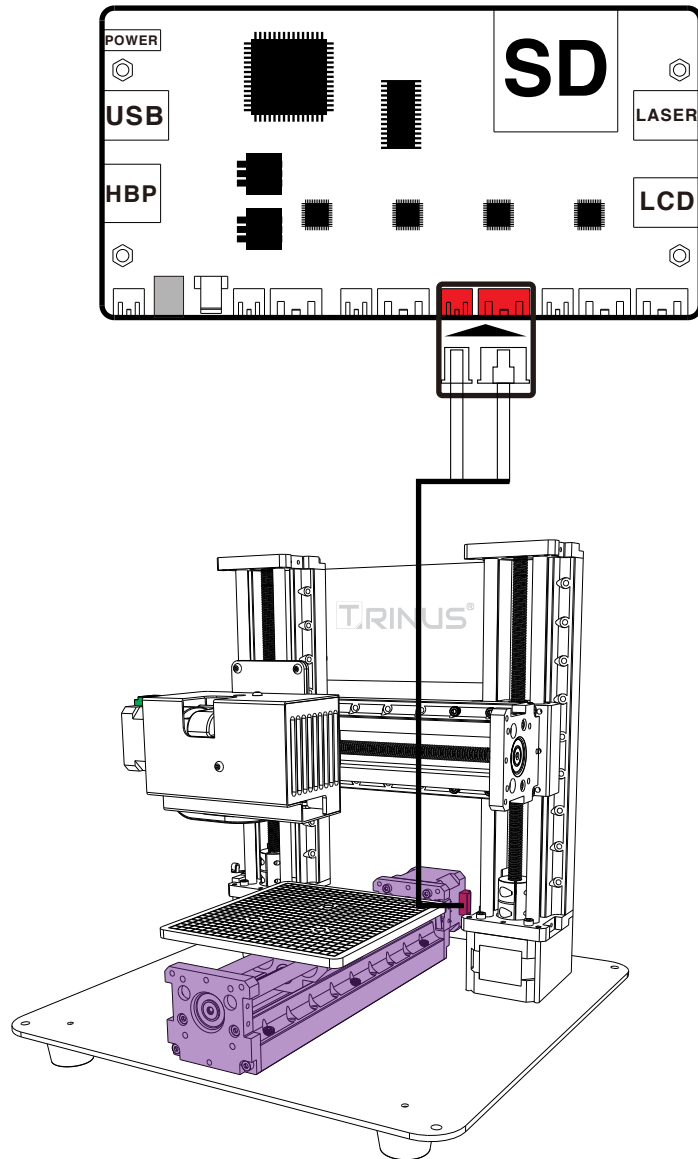

Connecting wires for the Z-Axis Module

